

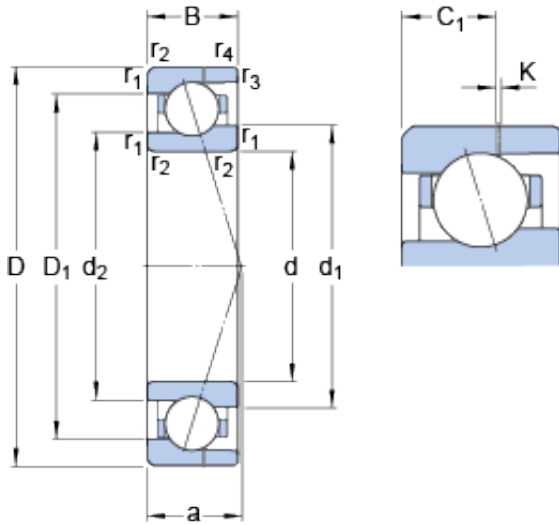

NTN Bearing Driveshaft USA CORP.



9 mm x 20 mm x 6 mm SKF 719/9 ACE/P4AH
Angular contact ball bearings

Bearing No. 719/9 ACE/P4AH

719/9 ACE/P4AH Bearing 2D drawings and 3D CAD models

Size	20x9x6 mm
Bore Diameter	20 mm
Outer Diameter	9 mm
Width	6 mm
d	9 mm
D	20 mm
B	6 mm
d ₁	12.5 mm
d ₂	11.76 mm
D ₁	16.52 mm
K	0.5 mm
C ₁	3.65 mm
r _{1,2} - min.	0.3 mm
r _{3,4} - min.	0.15 mm
a	6.9 mm
d _a - min.	11 mm
d _b - min.	11 mm
D _a - max.	18 mm
D _b - max.	19.2 mm
r _a - max.	0.3 mm
r _b - max.	0.15 mm
d _n	13.3 mm
Basic dynamic load rating - C	2 kN
Basic static load rating - C ₀	0.765 kN



NTN Bearing Driveshaft USA CORP.

Fatigue load limit - P_u	0.032 kN
Limiting speed for grease lubrication	100000 r/min
Limiting speed for oil lubrication	150000 mm/min
Ball - D_w	3.175 mm
Ball - z	11
G_{ref}	0.09 cm ³
Calculation factor - e	0.68
Calculation factor - Y_2	0.87
Calculation factor - Y_0	0.38
Calculation factor - X_2	0.41
Calculation factor - Y_1	0.92
Calculation factor - Y_2	1.41
Calculation factor - Y_0	0.76
Calculation factor - X_2	0.67
Preload class A - G_A	17 N
Preload class B - G_B	50 N
Preload class C - G_C	100 N
Calculation factor - f	1.03
Calculation factor - f_1	0.99
Calculation factor - f_{2A}	1
Calculation factor - f_{2B}	1.04
Calculation factor - f_{2C}	1.07
Calculation factor - f_{HC}	1
Preload class A	25 N/micron
Preload class B	37 N/micron
Preload class C	48 N/micron
d_1	12.5 mm
d_2	11.76 mm



NTN Bearing Driveshaft USA CORP.

D_1	16.52 mm
C_1	3.65 mm
$r_{1,2}$ min.	0.3 mm
$r_{3,4}$ min.	0.15 mm
d_a min.	11 mm
d_b min.	11 mm
D_a max.	18 mm
D_b max.	19.2 mm
r_a max.	0.3 mm
r_b max.	0.15 mm
d_n	13.3 mm
Basic dynamic load rating C	1.95 kN
Basic static load rating C_0	0.765 kN
Fatigue load limit P_u	0.032 kN
Attainable speed for grease lubrication	100000 r/min
Attainable speed for oil-air lubrication	150000 r/min
Ball diameter D_w	3.175 mm
Number of balls z	11
Reference grease quantity G_{ref}	0.09 cm ³
Preload class A G_A	17 N
Static axial stiffness, preload class A	25 N/ μ m
Preload class B G_B	50 N
Static axial stiffness, preload class B	37 N/ μ m
Preload class C G_C	100 N
Static axial stiffness, preload class C	48 N/ μ m
Calculation factor f	1.03
Calculation factor f_1	0.99
Calculation factor f_{2A}	1



NTN Bearing Driveshaft USA CORP.

Calculation factor f_{2B}	1.04
Calculation factor f_{2C}	1.07
Calculation factor f_{HC}	1
Calculation factor e	0.68
Calculation factor (single, tandem) Y_2	0.87
Calculation factor (single, tandem) Y_0	0.38
Calculation factor (single, tandem) X_2	0.41
Calculation factor (back-to-back, face-to-face) Y_1	0.92
Calculation factor (back-to-back, face-to-face) Y_2	1.41
Calculation factor (back-to-back, face-to-face) Y_0	0.76
Calculation factor (back-to-back, face-to-face) X_2	0.67
Mass bearing	0.008 kg